

ADVENT[®]

Model: LCDM40

4.0" LCD Rear Vision Mirror Monitor

Installation Manual



Features

- Mirror with built in 4.0" LCD Monitor
- Low Profile, Slim Design
- High Resolution TFT LCD
- Built in Speaker
- Two video inputs
- Fully Adjustable
- Auto screen brightness adjustment

Table of Contents

- Warnings 3
- Product Description 4
- Packing List 4
- Monitor Installation 5
- Monitor Wiring Diagram 8
- Specifications 8
- Troubleshooting 9

Warnings

The product is intended to assist in safe driving and to allow the driver to have a broader rear view while the vehicle is in reverse. You, as the driver, are solely responsible for the safe operation of your vehicle and the safety of your passengers according to local traffic regulations. Do not use any features of this system to the extent it distracts you from safe driving. Your first priority while driving should always be the safe operation of your vehicle. Audiovox Electronics Corporation cannot accept any responsibility whatsoever for accidents resulting from failure to observe these precautions or safety instructions.

1. This product utilizes high voltage. Any unauthorized modifications or damage to the product may result in electrical shock. Handle all components with care. Inspect regularly for damage to components and cabling.
2. You are responsible for ensuring that the installation of this product does not void or affect the vehicle manufacturer's warranty. Audiovox Electronics Corporation or its subsidiaries are not liable in full or in part for improper installation resulting in loss or damage to your property, or for voiding all or part of the vehicle manufacturer's warranty.
3. Do not apply excessive force to any of the components contained within this kit. Excessive force used before, during or after installation that results in a damaged or non-functional part will void all warranties.
4. Please follow the procedures in this installation manual. Improper installation or modification of this product will void all warranties.

Product Description

This advanced high resolution monitor will show a clear picture from a reversing camera or any other video source.

The modern thin design and easy factory mirror replacement allows the installation of a high quality LCD monitor securely in the vehicle without obstructing the drivers view.

The LCD is perfect for use in any vehicle with a rear vision mirror

This Monitor is designed for use with an Advent camera but is compatible with most video sources and other cameras and can be connected using a standard RCA connector.

Packing List

Parts	Barcode #	Quantity
4.0" Rear View Monitor	30262030	1
2.8M Extension Cable	30262160	1
5M Extension Cable (4-Pin)	30262170	1
S-Video (M) to RCA (F) Adaptor	30262410	1
Mounting Bracket (1 x Flat Tombstone, 1 x Toyota Adaptor)	30262060	2
Manual	30262020	1

LCD Monitor Installation

1. Remove the factory rear view mirror. (Use caution, some mirrors require specific tools to remove, seek additional help if you do not know how to remove a mirror).
2. Check and determine if the factory metal mounting lug is compatible with the mounting arm on the LCDM40 or with the Toyota/Honda adaptor supplied (see *Arm Adaptor* subsection).
 - a) If possible, attach the LCDM40 to the factory metal mounting lug and secure with the locking screw. Use caution to insure you do not pinch or damage the wiring coming through the mounting arm.
 - b) In some vehicles the factory metal mounting arm will not be compatible, if you find this situation then attach the supplied metal mounting lug to the window using Permatex Rearview Mirror Adhesive (Permatex Part # 11067-2) following the Permatex instructions closely. (Not included, Available from most auto parts stores). After dry mount the mirror to the mounting foot.
3. Examine the vehicle to determine the best way to run the power wires to: accessory power, the reverse lights and to the camera at the rear of the vehicle. **DO NOT CONNECT THE MIRROR UNTIL ALL CONNECTIONS HAVE BEEN MADE TO THE HARNESS.**
4. Run the wiring harness from the mirror under the headliner and down to the drivers side kick panel and under the dash.
5. Locate your vehicles reverse wire or run directly to the rear of the vehicle to the reverse lamp. Connect the orange (TRG1) wire to a wire that supplies +12 volts when in reverse. Connect the RED wire to +12 volts when the ignition is on. Connect your Camera to the extension cable directly or use the RCA adapter included. Use CAM1 connection for the primary camera. Connect the Black wire to a metal grounding location.
6. Connect to the CAM1 input for a secondary video source if desired. Order Audiovox Part# 30262410 if a second RCA adapter is required.

Note: When using an Advent Camera with your Advent Monitor the signal and power for the camera will be supplied through the monitor extension cable. Please also note that

when equipped with a microphone the audio will be heard on the speaker built into the mirror housing.

7. Follow the installation and wiring instructions for the camera you are using.
8. Connect the LCDM40 Monitor to the harness.
9. Power up and adjust on screen settings. In order to see an image you must be in Reverse gear.

NOTE: To adjust monitor settings press the MENU button on the bottom of the mirror to scroll through options. Use the + and – buttons to make adjustments as needed.

Arm Adaptor

Note: Used for installation in certain Toyota and Honda vehicles.

**If your vehicle has this
mount on the windscreen:**



**Then use this mounting
block:**



Following this installation procedure:



Wiring the Camera to the Vehicle's Reverse Lamp

1. Locate the reverse lamp in the tail light assembly.
2. Using the tap connector supplied, perform the following steps:
 - a) Place the un-stripped positive lead from the tail lamp in the run channel, which runs completely through the connector.
 - b) Insert the un-stripped red power wire from the camera completely into the other channel in the connector.
 - c) Make the connection between the wires by crimping down the metal connector with a pair of pliers, making sure the metal is flush with the plastic insulator.
 - d) Close the top plastic hinged cover until latched.
3. Attach the black wire to the ground (negative).
4. Repeat the above steps for the red wire.

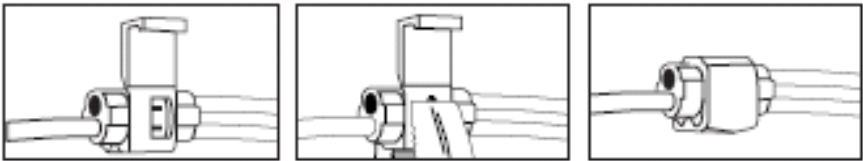

Monitor Wiring Diagram

Note: If used with an Advent camera – the power and signal will be provided through a single cable from the monitor.

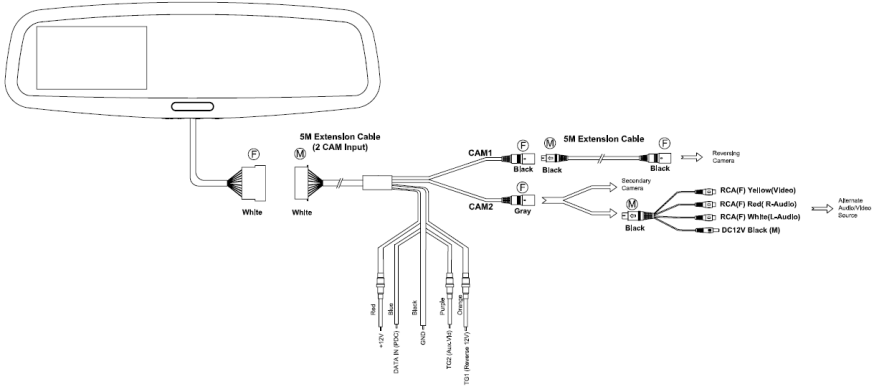

NOTE: The Blue wire will not be used, Tape off and do not connect.

Specifications

1. Voltage: DC12V
2. Power: 5w
3. Signal System: Switchable
4. LCD Viewing Angle: 170 degrees
5. Image Display: Selectable Normal/Reverse Image
6. Adjustable Mounting Angle

Troubleshooting

Symptom	Solution
No power to the monitor	<ol style="list-style-type: none">1. Check that reverse power is attached to orange wire.2. Check that accessory power is attached to red wire3. Check that black wire is attached to vehicle body (ground)4. Check fuse and if blown ONLY replace with a fuse of the same rating.
No image from backup camera when vehicle placed in reverse	<ol style="list-style-type: none">1. Check that camera is functioning correctly2. Check that orange wire is attached to reverse power.3. Check that backup camera is attached to input CAM1.
Image is mirrored or requires adjustment	<ol style="list-style-type: none">1. All settings are adjusted by pressing on the MENU button.
Sound can not be heard from Advent camera	<ol style="list-style-type: none">1. Increase volume through MENU button.2. Ensure Camera is connected using supplied extension cable